

Precision one-way flow control valves GRP

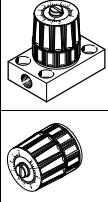

# Precision one-way flow control valves GRP

Product range overview and type codes

Product range overview									
Version	Valve function	Version	Type	Connection direction	Pneumatic connection 1	Pneumatic connection 2	qnN <sup>1)</sup> [l/min]	Adjustment component	→ Page/Internet
Precision one-way flow control valve	Metal One-way flow control function		GRP	-	G $\frac{1}{8}$	G $\frac{1}{8}$	40.7 ... 75.8	Rotary knob with scale	3
				-	PK-3, PK-4	PK-3, PK-4	3.8 ... 75.8	Rotary knob with scale	

1) Standard nominal flow rate in direction of flow control.

## Type codes

GRP - 70 -  $\frac{1}{8}$  - AL

### Type

GRP	Precision one-way flow control valve
-----	--------------------------------------

### Size

10, 70, 160
-------------

### Pneumatic connection 1, 2

Size 70, 160
--------------

$\frac{1}{8}$	Thread G $\frac{1}{8}$
---------------	------------------------

Size 10, 70
-------------

PK-3	Push-in connector for tubing with 3 mm I.D.
------	---

Size 160
----------

PK-4	Push-in connector for tubing with 4 mm I.D.
------	---

### Sub-base material

Thread G $\frac{1}{8}$
------------------------



AL	Wrought aluminium alloy
----	-------------------------

# Precision one-way flow control valves GRP

Technical data

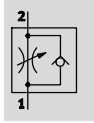
Function



-  Flow rate  
3.8 ... 75.8 l/min
-  Temperature range  
-10 ... +50 °C
-  Operating pressure  
0 ... 8 bar

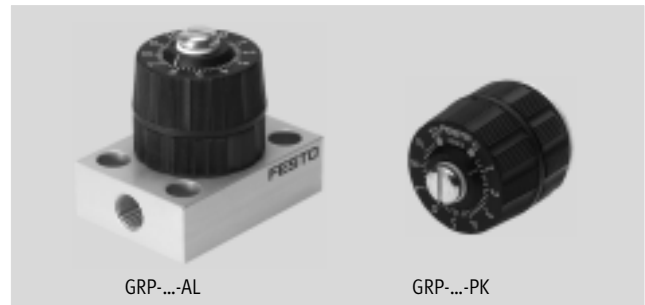

General technical data			
Valve function	One-way flow control function		
Type	GRP-...-AL	GRP-...-PK	
Pneumatic connection 2	G $\frac{1}{8}$	PK-3	PK-4
Pneumatic connection 1	G $\frac{1}{8}$	PK-3	PK-4
Adjustment component	Rotary knob with scale		
Actuation type	Manual		
Type of mounting	On sub-base	Front panel mounting	
Mounting position	Any		

-  - Note: This product conforms to ISO 1179-1 and to ISO 228-1

Operating and environmental conditions		
Operating pressure	[bar]	0 ... 8
Operating pressure 2 → 1	[bar]	0 ... 8
Operating medium	Compressed air in accordance with ISO 8573-1:2010 [5:4:3] Inert gases	
Note on operating/pilot medium	Operation with lubricated medium not possible	
Ambient temperature	[°C]	-10 ... +50
Temperature of medium	[°C]	-10 ... +50

## Materials

Sectional view

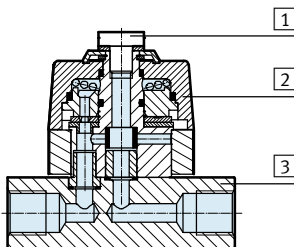

Precision one-way flow control valve GRP-...-AL	
1	Screws Steel
2	Housing PA, reinforced
3	Sub-base Wrought aluminium alloy
-	Seals NBR, PVC
Note on materials	RoHS-compliant Contains PWIS (paint-wetting impairment substances)

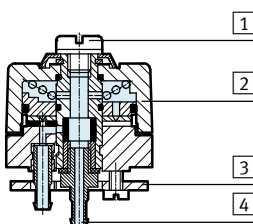

Precision one-way flow control valve GRP-...-PK	
1	Screws Steel
2	Housing PA, reinforced
3	Retainer Wrought aluminium alloy
4	PK connections Brass, wrought aluminium alloy
-	Seals NBR, PVC
Note on materials	RoHS-compliant Contains PWIS (paint-wetting impairment substances)

# Precision one-way flow control valves GRP

Technical data

FESTO

Standard nominal flow rate  $q_{nN}$  at 6 bar  $\rightarrow$  5 bar  
as a function of spindle rotations  $n$

Size 10

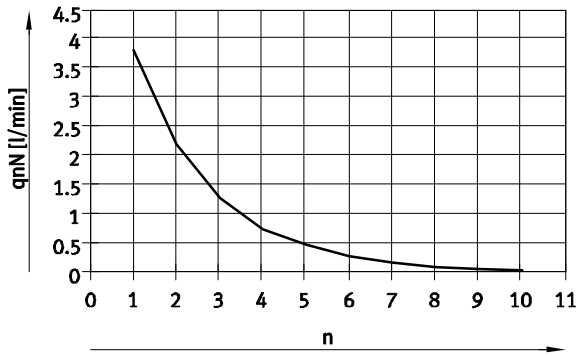

Standard flow rate  $q_n$  at 6 bar  $\rightarrow$  0 bar  
as a function of spindle rotations  $n$

Size 10

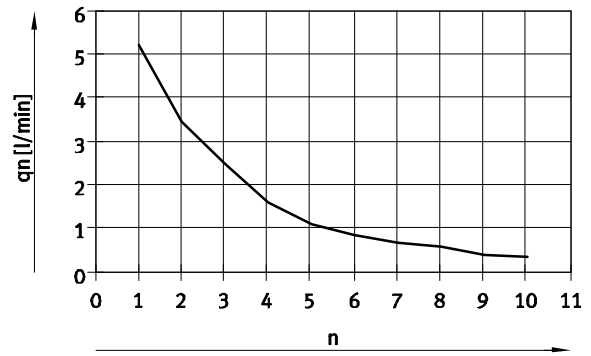

Size 70

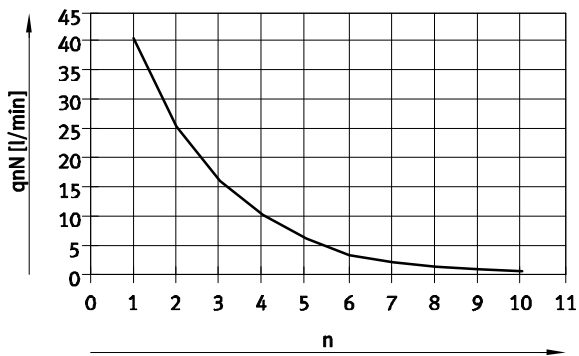

Size 70

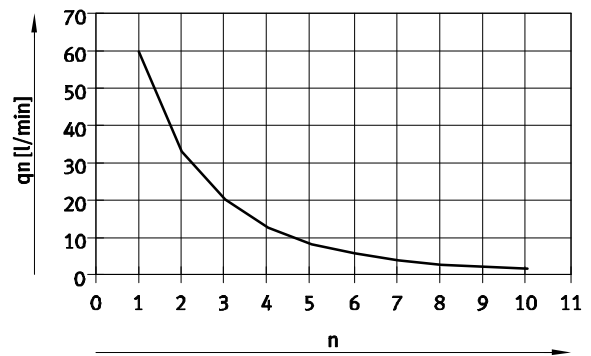

Size 160

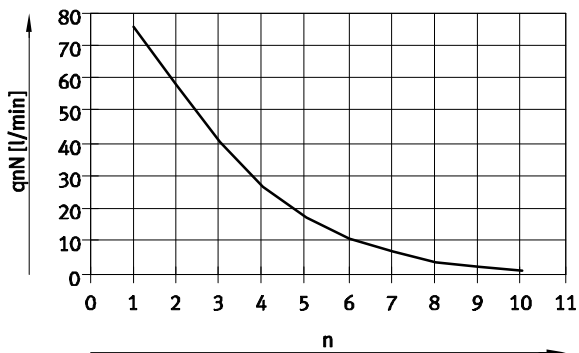

Size 160

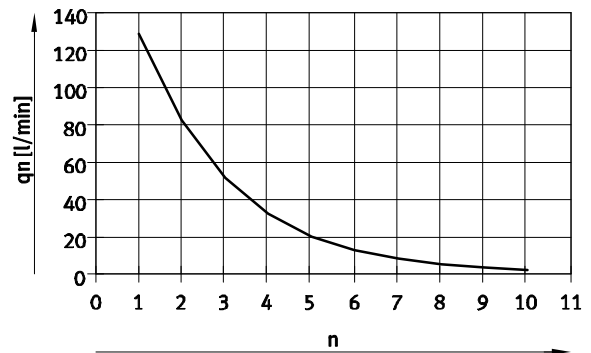

# Precision one-way flow control valves GRP

Technical data

## Standard flow rate $q_n$ at 1 bar $\rightarrow$ 0 bar as a function of spindle rotations $n$

Size 10

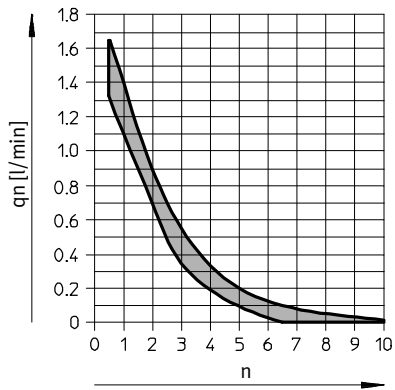

Size 70

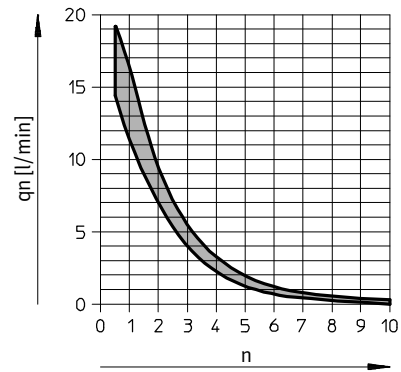

Size 160

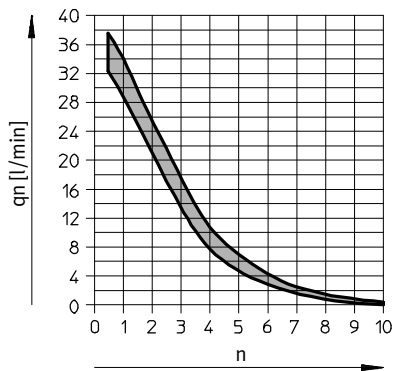

# Precision one-way flow control valves GRP

Technical data

FESTO

## Dimensions

Download CAD data → [www.festo.com](http://www.festo.com)

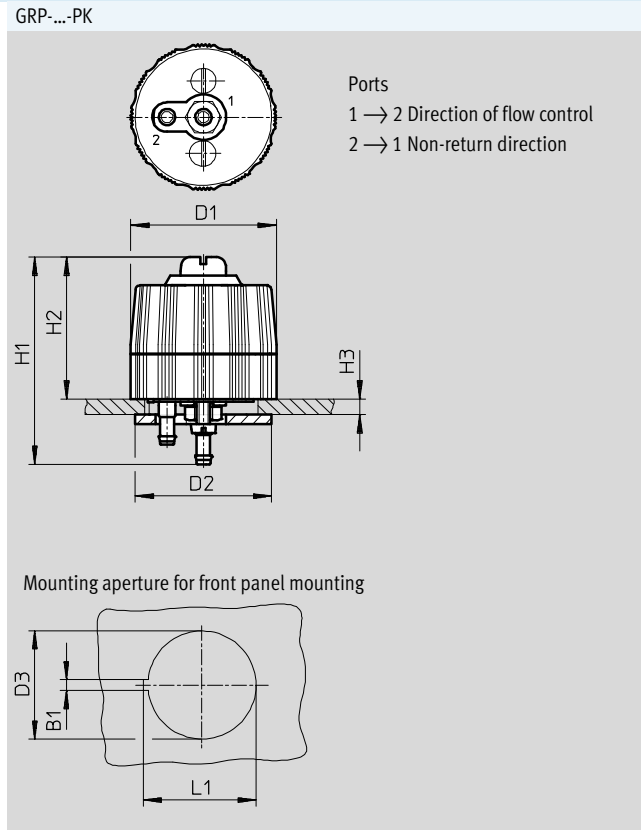
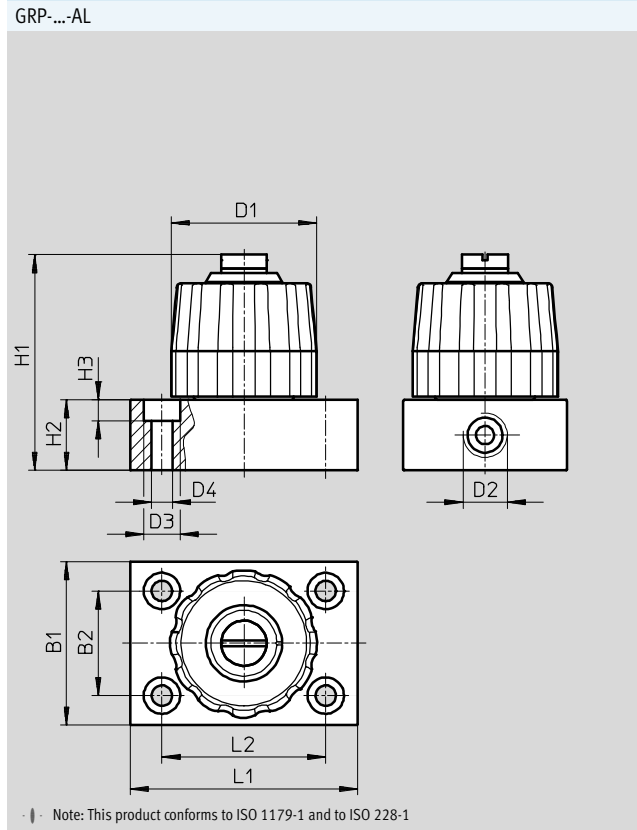

Type	Connection D2	B1	B2	D1	D3
GRP-70-1/8-AL	G1/8	36	23	32	8
GRP-160-1/8-AL					

Type	B1	D1	D2	D3
GRP-10/70-PK-3	2.6	32	30	22
GRP-160-PK-4				

Type	D4	H1	H2	H3	L1	L2
GRP-70-1/8-AL	4.5	47.4	15.5	4.6	50	36
GRP-160-1/8-AL						

Type	H1	H2	H3	L1
GRP-10/70-PK-3	45.6	31.2	1.5 ... 10	23.5
GRP-160-PK-4	44.5			

## Ordering data

	Pneumatic connection		Standard nominal flow rate q <sub>nN</sub> at 6 bar → 5 bar		Standard flow rate q <sub>n</sub> at 6 bar → 0 bar		Standard flow rate q <sub>n</sub> at 1 bar → 0 bar		Weight [g]	Part No.	Type
			In direction of flow control	In non-return direction	In direction of flow control	In non-return direction	In direction of flow control	In non-return direction			
			1	2	[l/min]	[l/min]	[l/min]	[l/min]			
Rotary knob with scale											
	G1/8	G1/8	40.7	88	60	127	19	20 ... 60	110	542022	GRP-70-1/8-AL
			75.8	245	129	245	38	25 ... 90	110	542023	GRP-160-1/8-AL
	PK-3	PK-3	3.8	95	5.2	131	1.65	15 ... 50	48	12743	GRP-10-PK-3
			40.7	88	60	127	19	20 ... 60	48	10802	GRP-70-PK-3
	PK-4	PK-4	75.8	245	129	245	38	25 ... 90	48	12961	GRP-160-PK-4

# Precision one-way flow control valves GRP

Accessories

**Mounting plates APL-2N-GRP**  
for precision one-way flow control  
valve GRP-...-PK

Material: PA

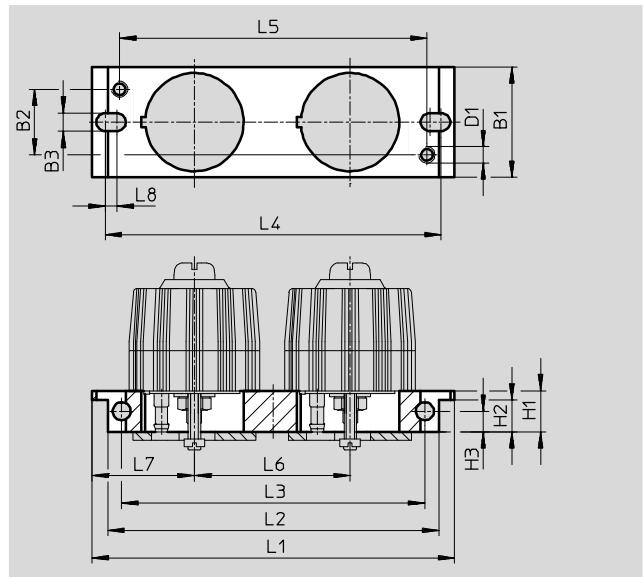

Dimensions															
B1	B2	B3	D1	H1	H2	H3	L1	L2	L3	L4	L5	L6	L7	L8	
26.8	16	4.4	M4	10	7.7	5	88.5	80.8	74	81	75	38	25	2.3	

Ordering data			
	Bore Ø [mm]	Weight [g]	Part No. Type
	22	16	10391 APL-2N-GRP
	2 x 22	22	10392 APL-2N-GRPX2