

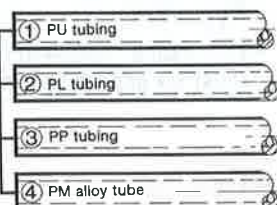

Quick push-pull coupling Type KCS-... self-closing

With these quick push-pull couplings, the plastic-coated alloy tube, Type PM, or PL, PP and PU tubing can be connected simply and quickly.

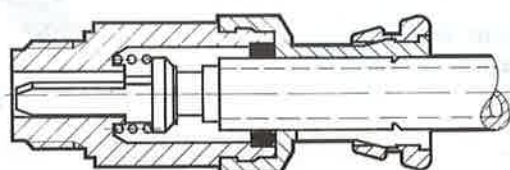
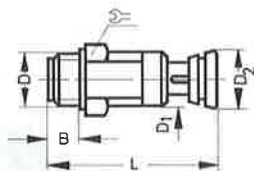

Order code		For tubing inside dia.	Connection D	Nominal size mm	Material	Weight kg	Dimensions				
Part No.	Type						B	D ₁	D ₂	L	
With metal connector and sealing ring											
10904	KCS-M5-PK-3	3	M 5	2.4	Steel/Plastic	0.010	3.5	10	10.5	46.5	8
10905	KCS-M5-PK-4	4/4	M 5	2.4		0.014	3.5	10	11.5	48.5	10
10356	KCS-1/8-PK-3	3	G 1/8	3	Aluminium Plastic 0 to 10 bar -10 to +60° C	0.007	5	14.2	12.5	37	13
10357	KCS-1/8-PK-4	4/4	G 1/8	4		0.007	5	14.2	14	39	13
10358	KCS-1/4-PK-4	4/4	G 1/4	4		0.011	6.5	14.2	14	41	17
10359	KCS-1/4-PK-6	6/5.2	G 1/4	6		0.011	6.5	16	17	44	17
10360	KCS-3/8-PK-6	6/5.2	G 3/8	6		0.015	8.5	16	17	46.5	19
Plastic design											
8731	KCS-1/8-PK-3-KU	3	G 1/8	3	Plastic with moulded sealing ring 0 to 10 bar -10 to +60° C	0.004	6.5	14.2	12.5	36.5	13
8732	KCS-1/8-PK-4-KU	4/4	G 1/8	4		0.005	6.5	14.2	14	38	13
8733	KCS-1/4-PK-4-KU	4/4	G 1/4	4		0.006	8.5	14.2	14	41	17
8734	KCS-1/4-PK-6-KU	6/5.2	G 1/4	6		0.007	8.5	16	17	43	17
8735	KCS-3/8-PK-6-KU	6/5.2	G 3/8	6		0.009	10.5	16	17	45.5	19

CS pliers Type ZCS for quick push-pull connectors

These pliers are used for connecting or disconnecting tubing and the alloy tube in areas where there is not much space available. They are also recommended for connecting large quantities of tubing.

Order code 9797 ZCS



Plastic-coated alloy tube Type PM-...

This metal tube is coated with plastic on both inside and outside and is used together with FESTO quick push-pull connectors. It can easily be shaped by hand.



Pressure range*		max. 20 bar				
Temperature range		-25 to +65° C				
Order code		Inside dia. mm	Outside dia. mm	Material	Weight kg/m	Min. bend- ing radius mm
Part No.	Type					
9084	PM-4	4	6	Polyethylene	0.024	19
9087	PM-6	5.2	8	Aluminium	0.032	25

* The maximum pressure is permissible at the maximum temperature