

## Flow control valve with swivelling connection

### Type GLRO-...-B

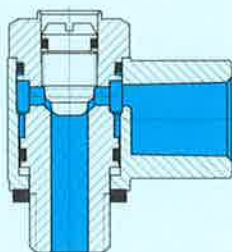

This throttle valve is used to regulate air flow, e.g. to control the piston speed in cylinders. The flow rate can be set in both directions using a throttle screw. The air flow is thus approximately equal in both directions.



Type GRLO-M5



Type GRLO-M5-PK-3

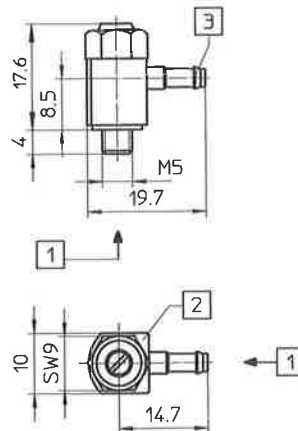

- 1 Throttling direction
- 2 360° rotatable
- 3 Barbed nipple for 3 mm plastic tubing

Type GRLO-M5

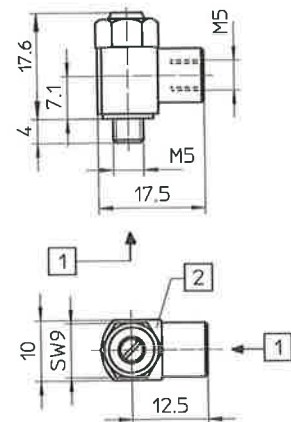

Flow rate as a function of turns of the adjusting screw (Q-s characteristic curve)

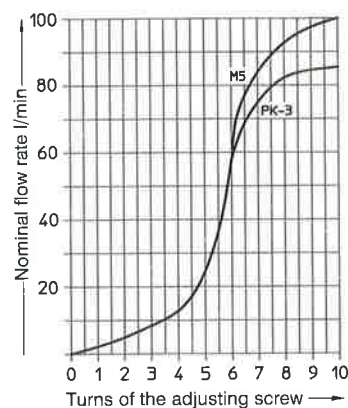

Order code	Part No./Type	151 181 GRLO-M5-B	151 182 GRLO-M5-PK-3-B
Medium		Compressed air, filtered (lubricated or unlubricated)	
Design		Flow control valve	
Mounting		Screwed connection	
Connection		M5	M5, connecting nipple for 3 mm tubing
Nominal bore		2 mm	
Standard nominal flow rate		100 l/min	85 l/min
Pressure range		0 to 10 bar	
Temperature range		– 10 to +60 °C	
Materials		Rotating connector: Die-cast Zn; hollow and adjusting screw: CuZn	
Weight		0.015 kg	0.010 kg