

# Engineering Change Notification

MS4, MS6 Products with optimized filter cartridge  
MS4-LF/LFR, MS6-LF/LFR, LF/LFR-DB-MINI product family

FESTO

## Reason of change

Technical improvement and harmonization of product design of MS4/6 and DB-MINI filter cartridge.

## Engineering Change Notification

## Technical changes

With the new filter cartridge design the **water removal efficiency will be significantly improved**. To reach this optimization the design were slightly changed (visible in the pictures).

All other technical values will keep the same quality.

Project No  
233908

Project Title  
Design  
Optimization MS4,  
MS6 and DB-MINI  
filter cartridge

Date  
05.04.2023

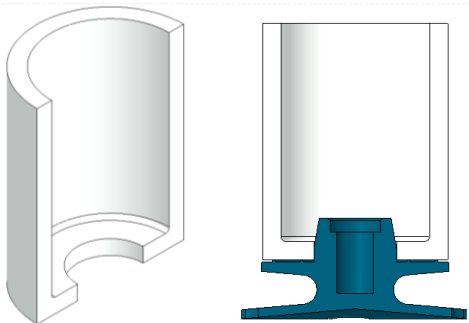
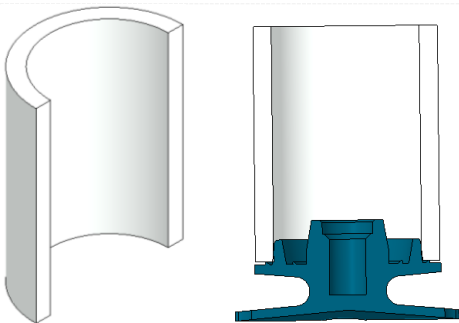
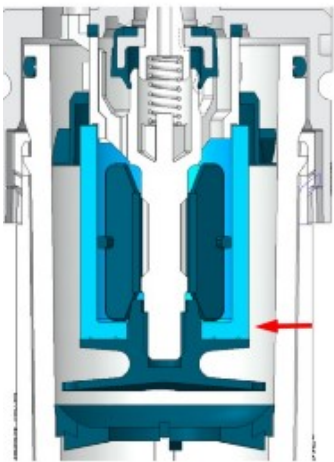
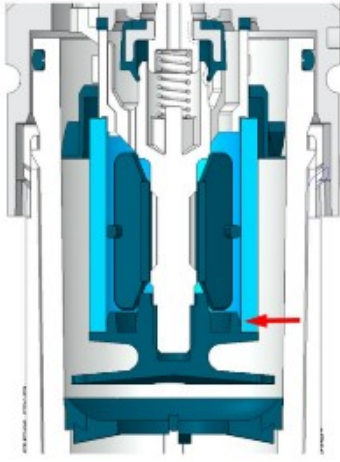
Previous Version	Future Version
old filter cartridge and separating disc	new filter cartridge and new separating disc
	
	

Page  
1 / 4

## Known technical implications

- **Function**

Improvement of the water removal efficiency

- **Environment**

There are no changes regarding environment

- **Interfacing**

With the new design of the filter cartridge itself, we introduced a new separating disc which fix the filter cartridge. All given products and filter cartridges (old/ new) are completely interchangeable without any quality losses.

DB-MINI is not affected by change of separating disc.

**You can choose! Order the old part-no or the new:**

**Old filter cartridge e.g. 534500 MS6-LFP-E:**

- **new cartridge** (4893002) + **new separating disc** (8142370)

**New filter cartridge e.g. 8129061 MS6-LFP1-E:**

- only a **new cartridge** (4893002, without separating disc)

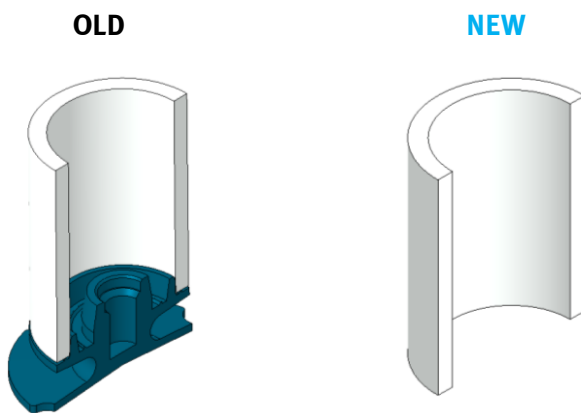

In addition we will also change the products over to the new filter cartridge + the new separating disc.

	<b>OLD LFR/ LF/ FRC</b> (filter regulator/ filter)	<b>NEW LFR/ LF/ FRC</b> (filter regulator/ filter)
<b>OLD filter cartridge</b>	✓ <b>compatible</b>	✓ <b>compatible</b>
<b>NEW filter cartridge</b>	✓ <b>compatible</b> ✓ improved water removal efficiency	✓ <b>compatible</b> ✓ improved water removal efficiency

### Affected products

Part No	Type
526489	filt. regulator MS4-LFR
527694	filt. regulator MS4N-LFR
526490	filt. regulator MS6-LFR
527667	filt. regulator MS6N-LFR
527695	Press regulator MS4-LF
527696	Press regulator MS4N-LF
527668	Press regulator MS6-LF
527669	Press regulator MS6N-LF
534499	filter cartridge MS6-LFP-C
534500	filter cartridge MS6-LFP-E
534501	filter cartridge MS4-LFP-C
534502	filter cartridge MS4-LFP-E
<div> <div>↓</div> <div>Please notice that for the “MINI” types you can directly use the new filter cartridge with the existing disk → the new disc cannot be used.</div> <div>↓</div> </div>	
537647	filt. regulator LFR-1/4-DB-7-O-MINI
537644	filt. regulator LFR-1/4-DB-7-5M-O-MINI
537645	filt. regulator LFR-1/4-DB-7-O-MINI-H
537646	filt. regulator LFR-1/4-DB-7-5M-O-MINI-H
539685	filt. regulator LFR-1/4-DB-7-MINI
539689	filt. regulator LFR-1/4-DB-7-5M-MINI
539686	filt. regulator LFR-1/4-DB-7-MINI-H
539690	filt. regulator LFR-1/4-DB-7-5M-MINI-H
537658	service unit FRC-1/4-DB-7-5M-MINI
537660	service unit FRC-1/4-DB-7-5M-MINI-H
537654	service unit FRC-1/4-DB-7-MINI
537656	service unit FRC-1/4-DB-7-MINI-H
8002800	service unit combination FRC-1/4-DB-7-MINI-KA
3339282	service unit combination FRC-1/4-DB-7-MINI-KA-MPA
8002801	service unit combination FRC-1/4-DB-7-MINI-KC
3339280	service unit combination FRC-1/4-DB-7-MINI-KC-MPA

## Estimated transition date

According to our current project schedule, the change will be productive approximately.

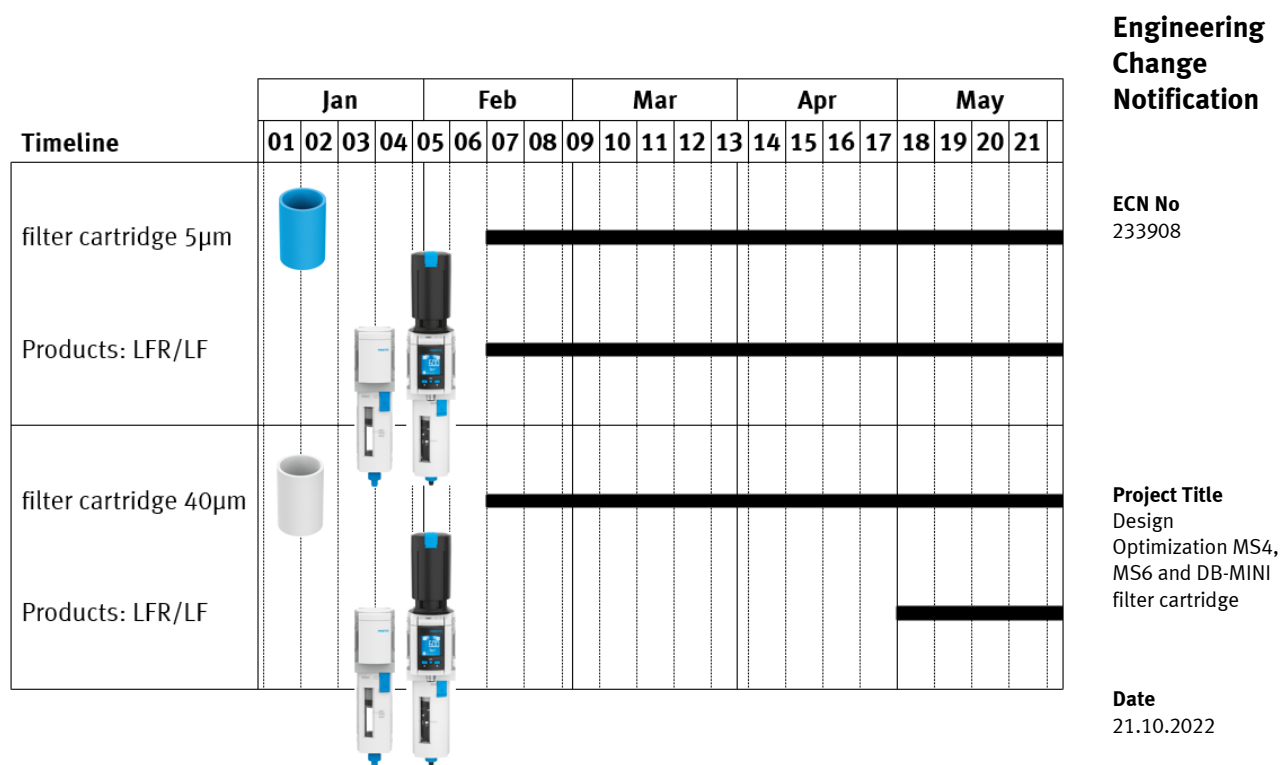

Please note, that the transition date can vary due to technical reasons and production needs.

## Release

Esslingen – Germany, 11.04.2023

	
Design	Quality Management Pneumatic Supply