



### **Recommended installation geometry for proportional valve VPWS**

This application note contains information on the installation geometry for customer-designed VPWS manifold solutions.

VPWS

Title .....Recommended installation geometry for proportional valve VPWS  
Version ..... 1.10  
Document no. .... 100828  
Original .....en  
Author .....Festo  
  
Last saved ..... 24.04.2026

### **General information:**

This document is intended for qualified, trained and instructed professionals. The data provided in this document are no guaranteed specifications, in particular with regard to functionality, condition or quality in the legal sense. The information in this document is intended only as simple indications for the implementation of a specific, hypothetical application, and in no way as a substitute for the operating instructions of the respective manufacturers or the design and testing of the respective application by the user. The respective operating instructions for Festo products can be found under [www.festo.com](http://www.festo.com). The user of this document must ensure that each function described herein works properly in his application. The user remains solely responsible for his or her own use of this document, even by studying this document and using the information mentioned therein. This also applies to any software (in source code and/or object code) that is made available to the user as an appendix to this document.

### **Rights of use of the software:**

If software is made available to the user as an appendix to this document, the user is granted a simple and unlimited right of use hereto. This right also includes the processing and distribution of the software to third parties in edited or unedited form. The User is not permitted to use the name "Festo" to endorse or promote products derived from the Software without express prior written permission.

Software is provided to the user "as is". Festo does not assume any warranty or guarantee with regard to software. Festo's liability for damages of any kind arising from the use of the software is limited to intent and gross negligence.

### **Legal Notices:**

©Festo SE & Co. KG, all rights reserved. A change in content and form is only permitted with the express written consent of Festo SE & Co. KG. Festo grants the user the right to reproduce this document in a form that remains unchanged in terms of content and form and to pass it on to third parties.

# Table of contents

- 1 Introduction ..... 5
- 2 Recommendation for VPWS-6-... ..... 6
- 3 Recommendation for VPWS-1-.../ VPWS-1.5-.../ VPWS-2.2-..... 7
- 4 Recommendation for VPWS-0.3-... ..... 8



## 1 Introduction

This application note contains additional information for an optimized manifold geometry for customers who are designing their own VPWS manifolds.

The following should be noted as well:



### Note

Please observe maximum axial valve mounting force (first line in each picture below). Higher forces can destroy the valve (the two halves of the VPWS valve are pressed into each other, reducing the stroke and thereby the flow).

Maximum axial mounting force:

VPWS version	Force, N
VPWS-6	200 N
VPWS-2.2/1.5/1	200 N
VPWS-0.3	30 N

Table 1.1: Mounting forces

It helps to use a little grease at the valve O-rings for the mounting.

Alternatively you can use Isopropanol for the mounting of the valve into the manifold.

When designing the manifold block for the VPWS-6 valves:

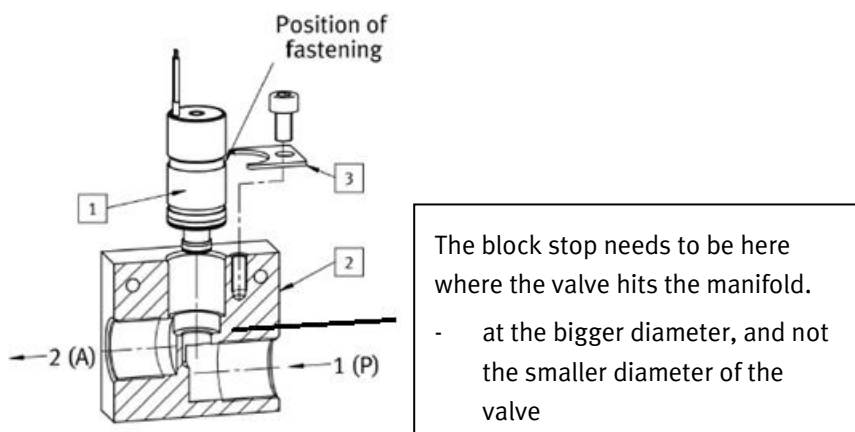

The lower part of the valve consists of two parts and it needs to be avoided to push in the smaller diameter part into the main body of the valve.

The drawings on the next pages for the different VPWS valve types especially highlight the edges to allow for an easier mounting of the VPWS valves without damaging the O-rings.

Please check the mounting geometry of the VPWS valve in your manifold.

Check for the edges, check for the tolerances

## 2 Recommendation for VPWS-6-...

Manifolds for VPWS-6\_\* (parts 8074537 and 8074538):

Max. valve mounting force 200N

Tolerancing ISO 8015

Edges +/-0,2 acc. ISO 13715

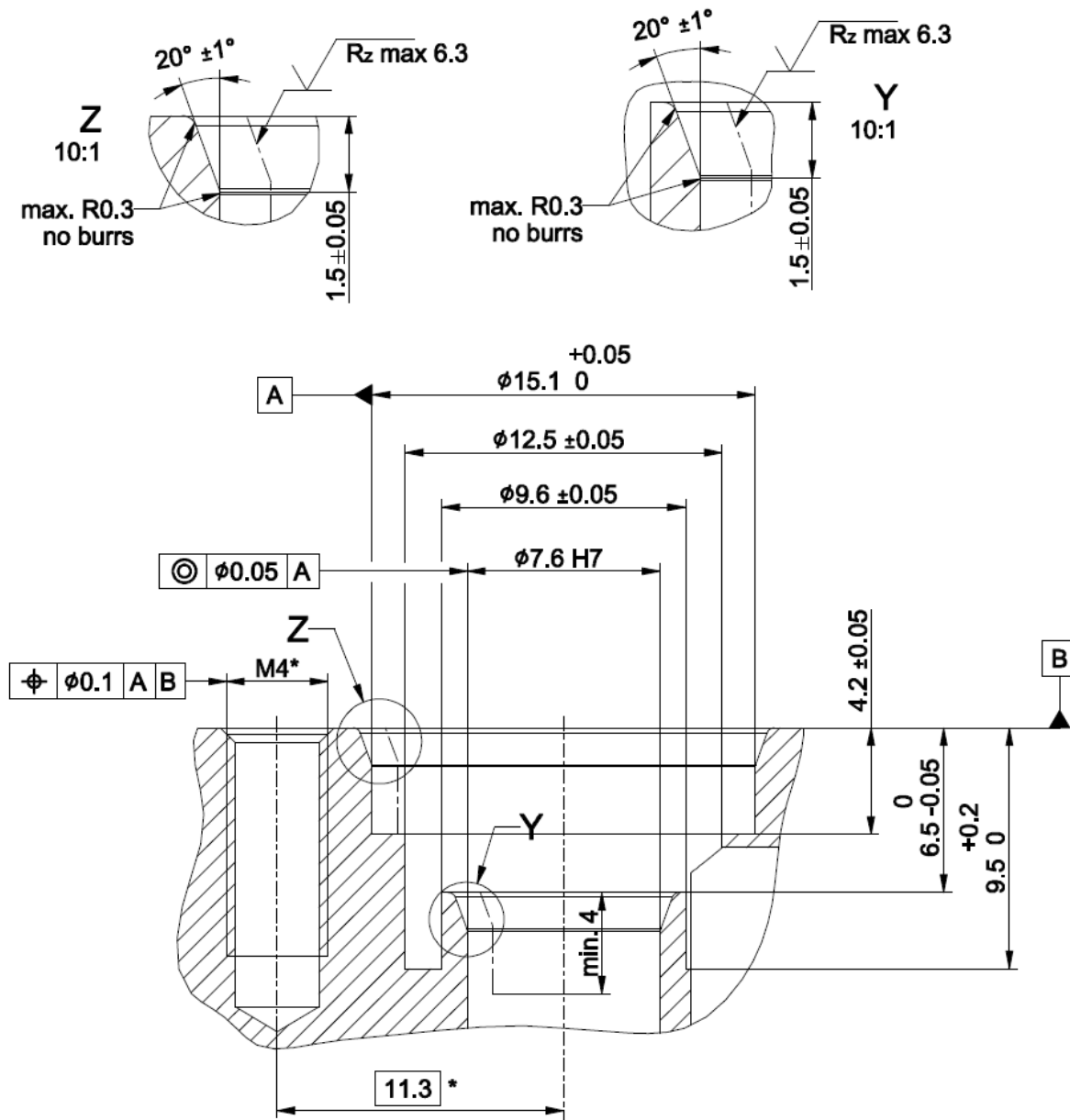

\* only needed if mounting VAME-P4-PC15-P-P10 is used

### 3 Recommendation for VPWS-1-.../ VPWS-1.5-.../ VPWS-2.2-...

Manifolds for VPWS-1-\*/1.5-\*/2.2-\* (parts 8186783, 8074075 and 8074074):

Max. valve mounting force 200N

Tolerancing ISO 8015

Edges +/-0,2 acc. ISO 13715

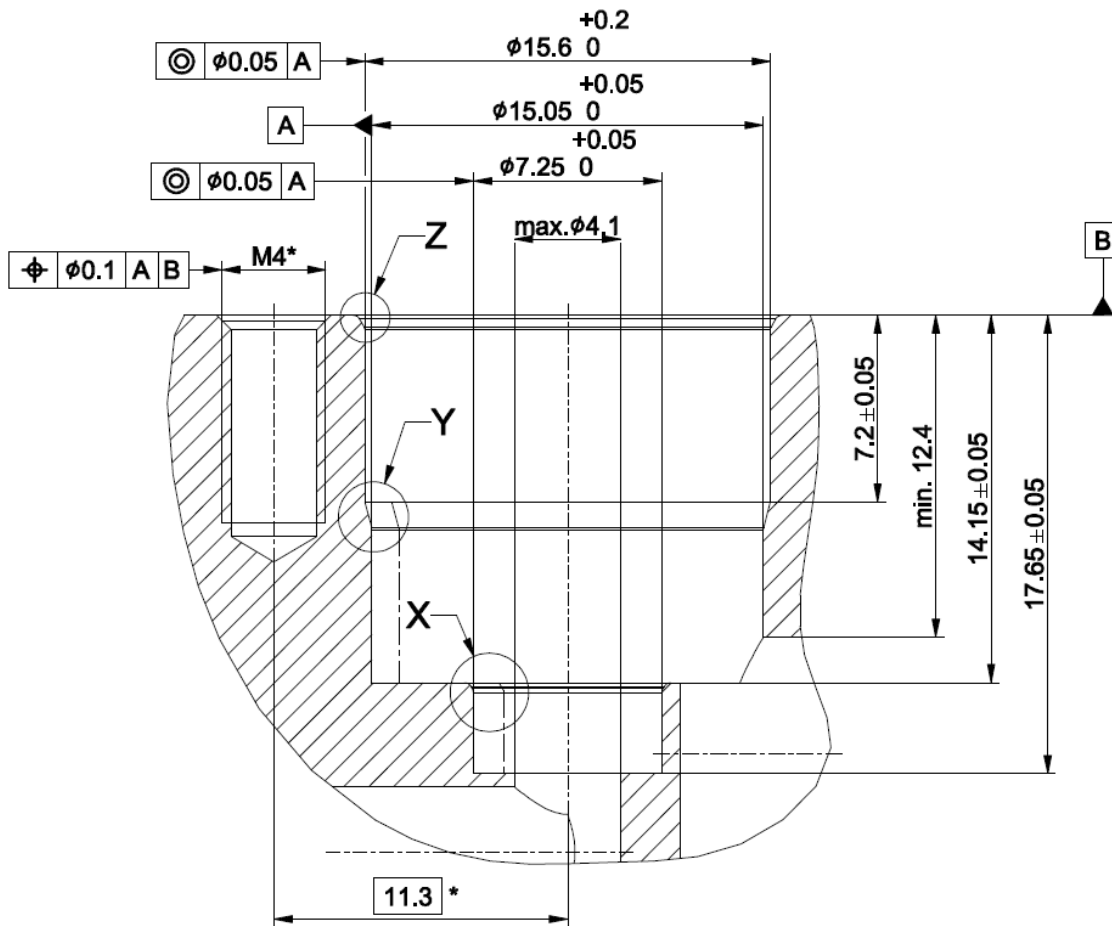
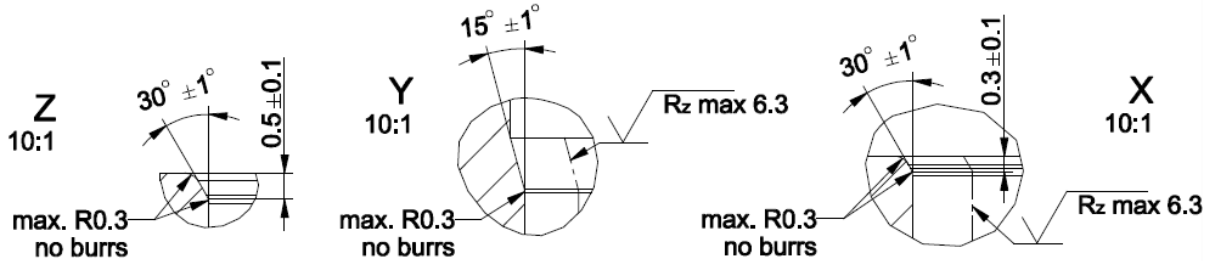

\* only needed if mounting VAME-P4-PC15-P-P10 is used

