

- Reduced weight thanks to optimal use of materials with sheet-metal structures
- Protection against environmental influences and unauthorised access
- Ideally combined as a control cabinet directly in the system

A sheet-metal structure acts as a support for pneumatic and electrical components. The well thought-out design makes it possible to get the most out of the material used. Upright steel parts perform the function of mounting brackets in this

case. This means fewer components and reduced weight, making the entire system into a compact unit.

Special housings protect electric and pneumatic components against environmental influences and unauthorised ac-

cess. They also lend applications a more attractive appearance. They are developed for specific applications in a space-saving design.

When combined, sheet-metal structures

and special housings produce a small control cabinet which can be fitted directly in or on the application. The resulting short tubing and cable lengths significantly shorten the switching times.

#### Technical data

- Sheet-metal structures
  - Customised shape and size
  - Reduced weight and number of assembly parts

- Special housing
  - Customised shape (flat, curved, rectangular, etc.)
  - Customised dimensions
  - Different materials (metal, aluminium, polymer, etc.)
  - Compact, space-saving format
  - Protection against environmental influences and unauthorised access

- In combination
  - Alternative to conventional control cabinets
  - Variable integration options on and within the machine
  - Short tubing and cable lengths
  - Attractive design

#### Ready-to-install – the benefits to you

##### Engineering

Complete engineering solution according to your application-specific requirements by Festo specialists.

##### Production and assembly

The entire production and assembly process is taken care of for you.

##### Checking and testing

The solution is fully tested.

##### Documentation

You receive detailed system documentation, which you can quickly and easily integrate into your overall documentation:

Interested in sheet-metal structures and special housings?

Ask your Festo sales engineer, who will be happy to help.

Or visit your local website at [www.festo.com](http://www.festo.com),

where you will find further information on ready-to-install solutions.

# Sheet-metal structures and special housings

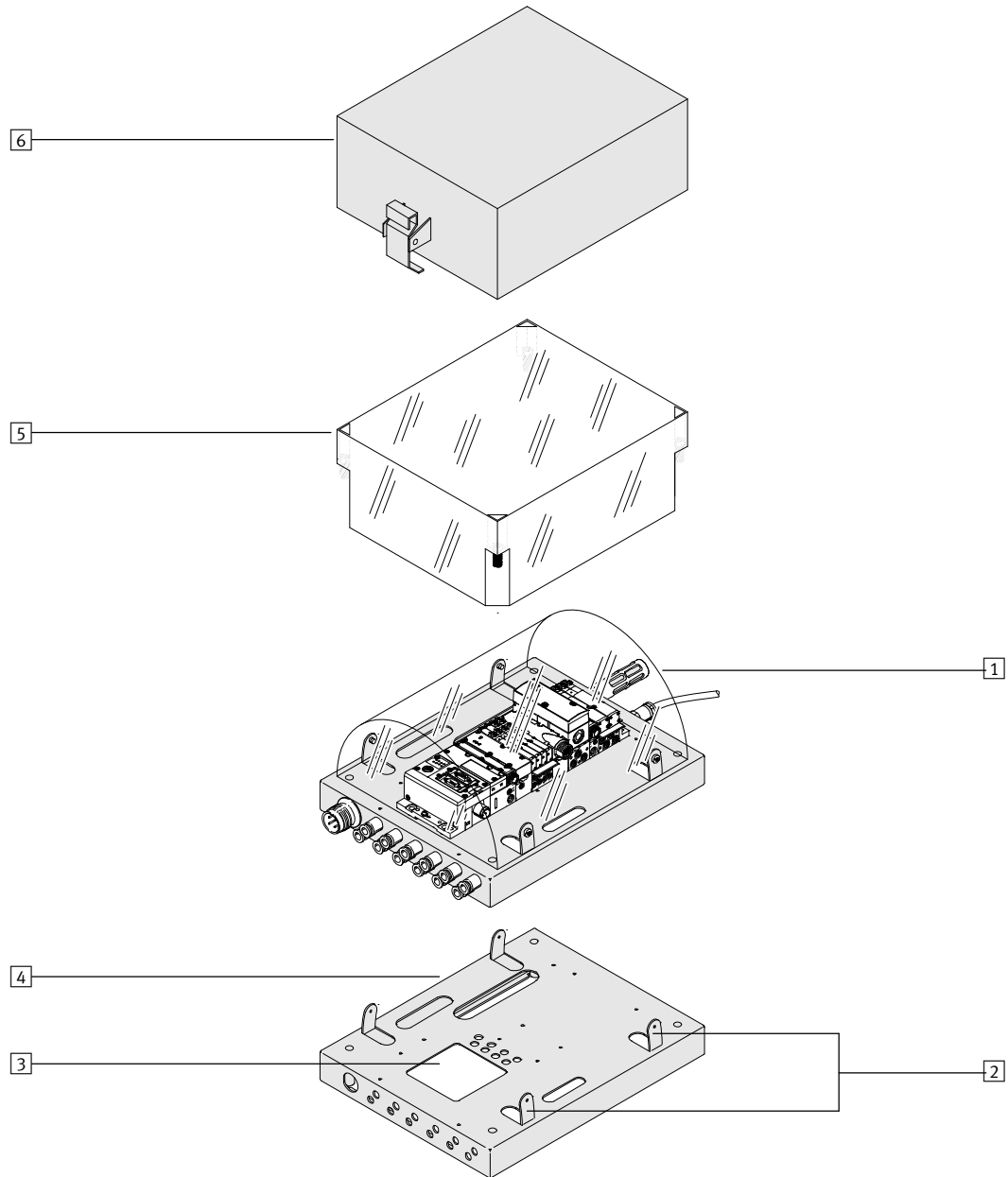

- 1** One basic solution
  - Small control cabinet
- 2** Upright sheet-metal parts
  - As mounting brackets
- 3** Cut-outs
  - For tubing
  - For connections
  - etc.

- 4** Sheet-metal structure
  - Customised dimensions
  - Customised shapes

- 5** Material
  - Metal
  - Polymer
  - etc.

- 6** Special housing
  - Customised dimensions
  - Customised shapes (flat, curved, etc.)