

FESTO

Festo SE & Co. KG

Postfach
73726 Esslingen
Germany
+49 711 347-0
www.festo.com

Connecting cable NEBV-S1WA...-K...-LE...-S9

1. Applicable documents

All available documents for the product → www.festo.com/pk

2. Intended use

Connecting cable for valve terminals with multi-pin.

3. Design

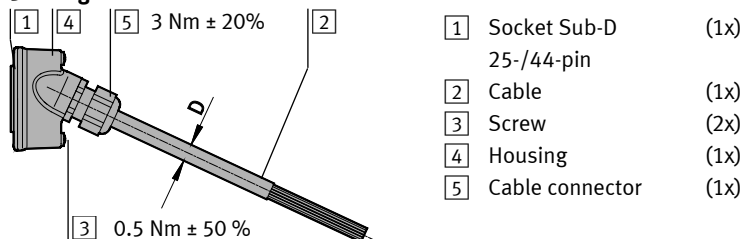

4. Position of the pins

Socket **1** (25-pin)

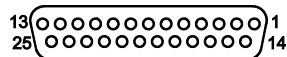

Socket **1** (44-pin)



5. Changing the alignment of the socket **1**

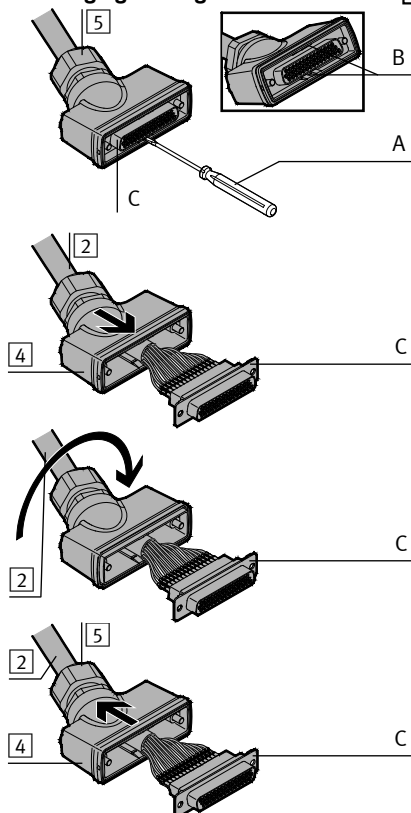

- Unscrew cable connector **5**.
- Push screwdriver (A) (blade 3 mm) into the openings (B).
- Pry out socket insert (C) on both sides.
- Push cable **2**, including the socket insert (C), out of the housing **4**.

- Turn cable **2** 180°.
- Socket insert (C) turns as well.

- Push socket insert (C), including the cable **2**, into the housing **4**.
- Latch socket insert (C).
- Tighten cable connector **5**. Observe the tightening torque.

6. Pin allocation

Colour code ¹⁾	Pin	
	SUB-D 25-pin	Sub-D 44-pin
WH	1	1
BN	2	2
GN	3	3
YE	4	4
GY	5	5
PK	6	6
BU	7	7
RD	8	8
BK	9	9
VT	10	10
GYPK	11	11
RDBU	12	12
WHGN	13	13
BNGN	14	14
WHYE	15	15
YEEN	16	16
WHGY	17	17
GYBN	18	18
WHPK	19	19
PKBN	20	20
WHBU	21	21
BNBU	22	22
WHRD	23	23
BNRD	24	24
WHBK	25	25
BNBK	-	26
GYGN	-	27
YEGY	-	28
PKGN	-	29
YEPK	-	30
GNBU	-	31
YEBU	-	32
GNRD	-	33
YERD	-	34
GNBK	-	35
YEBK	-	36
GYBU	-	37
PKBU	-	38
GYRD	-	39
PKRD	-	40
GYBK	-	41
PKBK	-	42
BUBK	-	43
RDBK	-	44

7. Technical data

NEBV-S1WA...-K...-LE...-S9	S1WA25	S1WA44	
Cable composition	[mm ²]	25x0.34	44x0.14
Current rating	[A]	2.6	2.0
Operating voltage range DC	U _B [V]	0 ... 30	0 ... 30
Surge resistance	[kV]	2.4	2.4
Cable diameter	D [mm]	10.2 ± 0.25	10.2 ± 0.3
Cable bending radius			
Fixed cable installation	R [mm]	≥ 41	
Flexible cable installation	R [mm]	≥ 122	
Protection class in mounted status		IP65/IP67	
Ambient temperature			
Fixed cable installation	[°C]	-35 ... +80	
Flexible cable installation	[°C]	-5 ... +80	
Cable sheath material		PVC	

¹⁾ Colour code in accordance with IEC 60757:1983-01