

Electrical toothed belt axes with internal roller guide DGE..-RF

FESTO



Dynamic!

High speed in the DGE range with the toothed-belt axis DGE...-RF with roller bearing guide. Silent and highly dynamic – thanks to the internal roller guide.

In strong demand

The DGE-RF picks up where the electrical axis DGE-KF leaves off:

available with the DGE-RF.

Harmonised and of course extensively tested!

Virtually silent

The DGE-RF boasts extremely short cycle times of 10 m/s, but with a minimum of noise!

Manufacturer-independent

The coupling concept supports the attachment of non-Festo drives.

Well lubricated

The DGE-RF has sufficient grease reserves for 10,000 km without lubrication that can be easily replenished without having to reach into the housing.

Fully compatible

The DGE-RF adapts to the multi-axis modular system. The mounting options on three sides of the main profile are ideal for standardised mechanical interfaces.

Perfectly matched

Axes, motors, gear units, couplings and controllers – are all

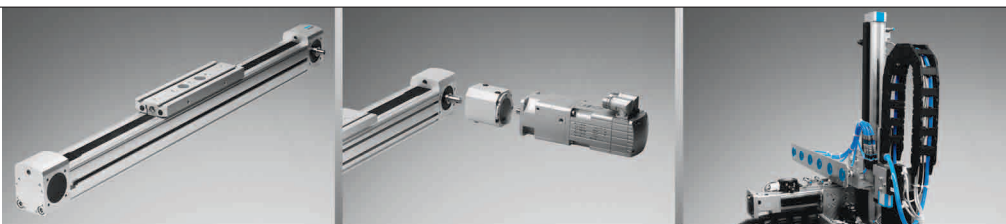

Simple,

harmonised,

a perfect fit!

130.1.PSI →

Product Short Information

Electrical toothed belt axes with internal roller guide DGE..-RF



Modern drives – Systematically more economical!

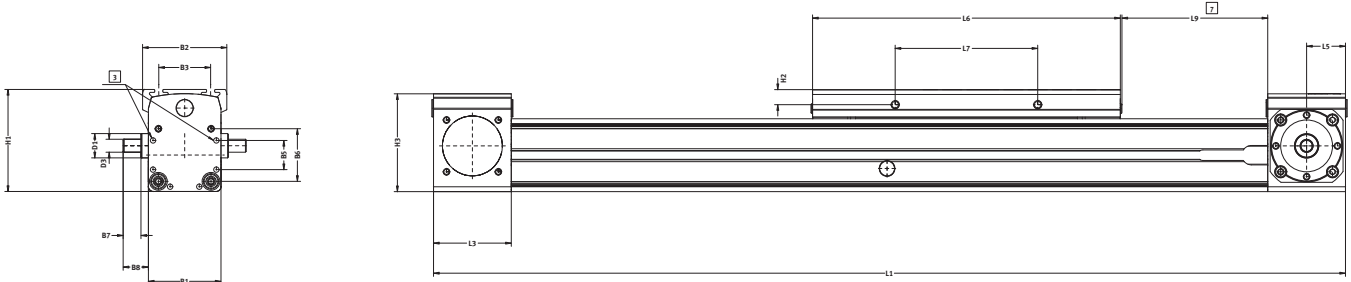

General technical data

Type	D1	D2	D3	D4	D5	D6	D7	B1	B2	B3	B4	B5	B6	B7	B8	B9
DGE-25-ZR-RF- (GK)																
DGE-25-ZR-RF-GV	15	M4	∅ 8	∅ 37	M4	M5	∅ 3.3	45	52	32	39.1	18	32.5	11	15.6	31.8
DGE-40-ZR-RF- (GK)																
DGE-40-ZR-RF-GV	20	M5	∅ 15	∅ 47	M5	M5	∅ 4.4	64	85	55	53	28	49	24.5	29.6	45.5
DGE-63-ZR-RF- (GK)																
DGE-63-ZR-RF-GV	35	M8	∅ 25	∅ 80	M8	M8	∅ 6.4	106	128	90	89	44	83	35.2	41.1	74.3

Note:

- 1 Coupling housing
- 2 Mounting slot
- 3 Centring hole for foot mounting
- 5 Hole for centring sleeve
- 7 Stroke reserve

Type	B10	B11	B12	B13	H1	H2	H3	H4	H5	H6	H7	H8	H9	L1	L2	L3
DGE-25-ZR-RF- (GK)														414	207	
DGE-25-ZR-RF-GV			14.6	3.6	63	9.3	60.4	19.6	22.5	16	5.8	32	30	509	254.5	48
DGE-40-ZR-RF- (GK)														638	319	
DGE-40-ZR-RF-GV	20	24	22.8	-2.2	86	9.5	83.8	26.5	32	19.5	8.8	30	37	778	389	67
DGE-63-ZR-RF- (GK)														1020	510	
DGE-63-ZR-RF-GV	40	50	35	0	131	10.5	129.3	44.5	52.8	27.5	10.1	49	44.6	1250	625	106

Type	L4	L5	L6	L7	L8	L9	L10	n	T1	T2	T3	T4	T5	T6	T7
DGE-25-ZR-RF- (GK)			190												
DGE-25-ZR-RF-GV	32	24	285	88	1	63			10	7	8.5	<1.6	2	8	3
DGE-40-ZR-RF- (GK)			300												
DGE-40-ZR-RF-GV	54	34	440	58	2	100	40	2	12	12	8.5	<2.9	3	12	5
DGE-63-ZR-RF- (GK)			460				40	2							
DGE-63-ZR-RF-GV	84	55	690	72	2	172	80	4	21	22	12	<5.1	4	15	6.5

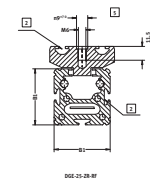
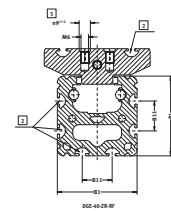
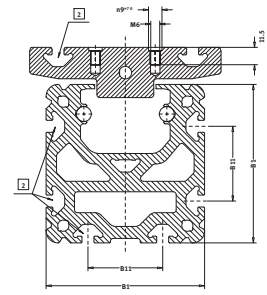

	DGE-25-RF		DGE-40-RF		DGE-63-RF	
Guide	internal roller guide					
Max. working load	[kg]		15		30	
Max. nominal stroke	[mm]		5000		5000	
Max. speed	[m/s]		10		10	
Repetition accuracy	[mm]		±0.1		±0.1	
Slide length	[mm]		190	285	300	440
Max. force F _x	[N]		260		610	
Max. force F _y	[N]		150		300	
Max. force F _z	[N]		150		300	
Max. torque load M _x	[Nm]		7		18	
Max. torque load M _y	[Nm]		15	30	60	120
Max. torque load M _z	[Nm]		15	30	90	180

Stroke length 4.500 mm for version with extended slide.

Festo AG & Co. KG

Ruiter Strasse 82
73734 Esslingen
Internet www.festo.com
Tel. ++49 (0)711 347-0
Fax ++49 (0)711 347-21 44
E-mail service_international@festo.com

* Tested representatively and certified for the products ADVU, DGPL and DNC.