

Solenoid valves MEBH, ISO 5599-1

Technical data – 5/2-way valves

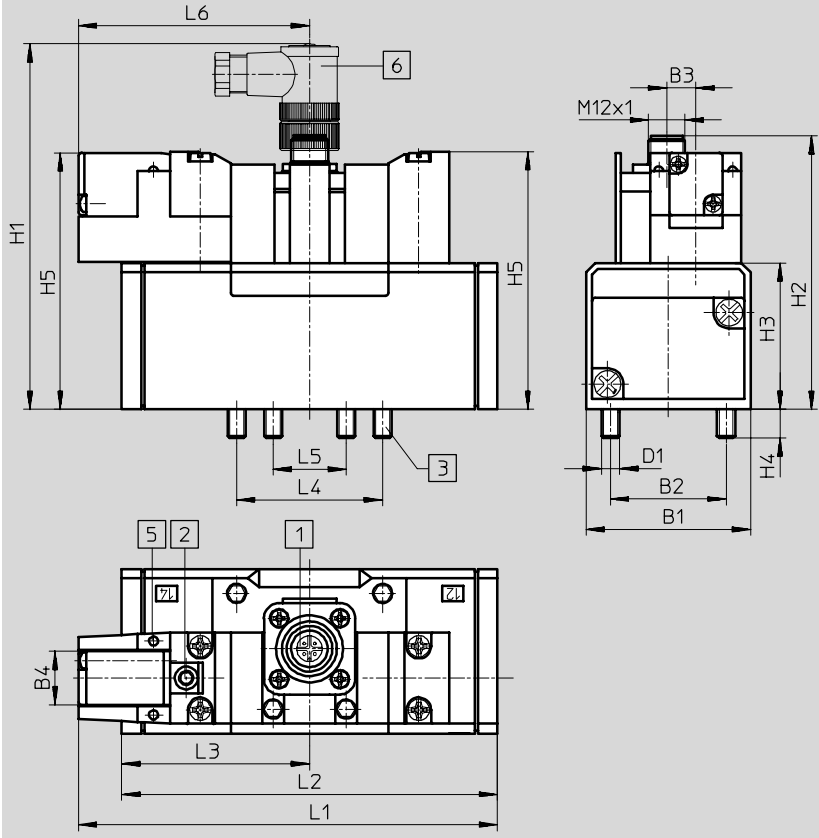

Dimensions Download CAD data → www.festo.com/en/engineering



- 1 Attachment of plug socket adjustable by 3x 30°
- 2 Manual override
- 3 Captive mounting screws
- 5 LED display
- 6 Angled socket SEA-M12-4WD-PG7 → 2 / 1.2-102

| Type | B1 | B2 | B3 | B4 | D1 | H1 | H2 | H3 | H4 | H5 | L1 | L2 | L3 | L4 | L5 | L6 |
|-------------------|----|----|----|------|----|-----|------|----|-----|------|-------|-------|------|----|----|------|
| ISO size 1 | | | | | | | | | | | | | | | | |
| MEBH-5/2-... | 42 | 28 | 6 | 17.5 | M5 | 110 | 80.3 | 38 | 9 | 74.7 | 110.8 | 87.6 | 43.8 | 36 | 18 | 67 |
| MEBH-5/2-...-FR | | | | | | | | | | | 121.3 | 98 | | | | |
| ISO size 2 | | | | | | | | | | | | | | | | |
| MEBH-5/2-... | 54 | 38 | 9 | 17.5 | M6 | 120 | 90.1 | 48 | 9.5 | 84.2 | 137.6 | 123.4 | 61.7 | 48 | 24 | 75.9 |
| MEBH-5/2-...-FR | | | | | | | | | | | 154.9 | 140.7 | | | | |
| ISO size 3 | | | | | | | | | | | | | | | | |
| MEBH-5/2-... | 65 | 48 | 12 | 17.5 | M8 | 130 | 97.8 | 55 | 12 | 93.1 | 158.7 | 145.4 | 72.7 | 64 | 32 | 86 |
| MEBH-5/2-...-FR | | | | | | | | | | | 178 | 164.7 | | | | |

M12 central plug – Terminal allocation

Mono connection

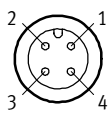

- 1 Unused
- 2 Unused
- 3 com (-)
- 4 Signal (+) Solenoid 14