

End plate CPX-M-EPL-EV-X

Part number: 576317

FESTO

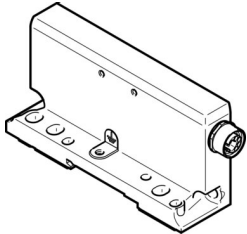

 [General operating condition](#)

Data sheet

| Feature | Value |
|----------------------------------|-------------------------|
| Type of mounting | Angled fitting |
| Product weight | 190 g |
| Corrosion resistance class (CRC) | 0 - No corrosion stress |
| LABS (PWIS) conformity | VDMA24364-B2-L |
| Certification | c UL - Recognized (OL) |
| Note on materials | RoHS-compliant |
| Housing material | Die-cast aluminum |
| Max. power supply | 6 A |